

# U 96

---

# U-BOAT

## Pack 28

### Assembly Instructions

**Kit 109: Aft diving plane**

**Kit 110: A new hull section**

**Kit 111: Another hull section**

**Kit 112: Port tail section**



Hachette Partworks Ltd  
4th Floor, Jordan House,  
47 Brunswick Place, London, N1 6EB  
[www.U96-collection.com](http://www.U96-collection.com)

© 2025 Hachette Partworks Ltd.  
ALL RIGHTS RESERVED  
Not suitable for children under 14.

**WARNING:** All parts belong to a kit.  
Collectors' item for adults. Not suitable for  
children under 14. Some parts may have  
sharp edges, please handle them with care.

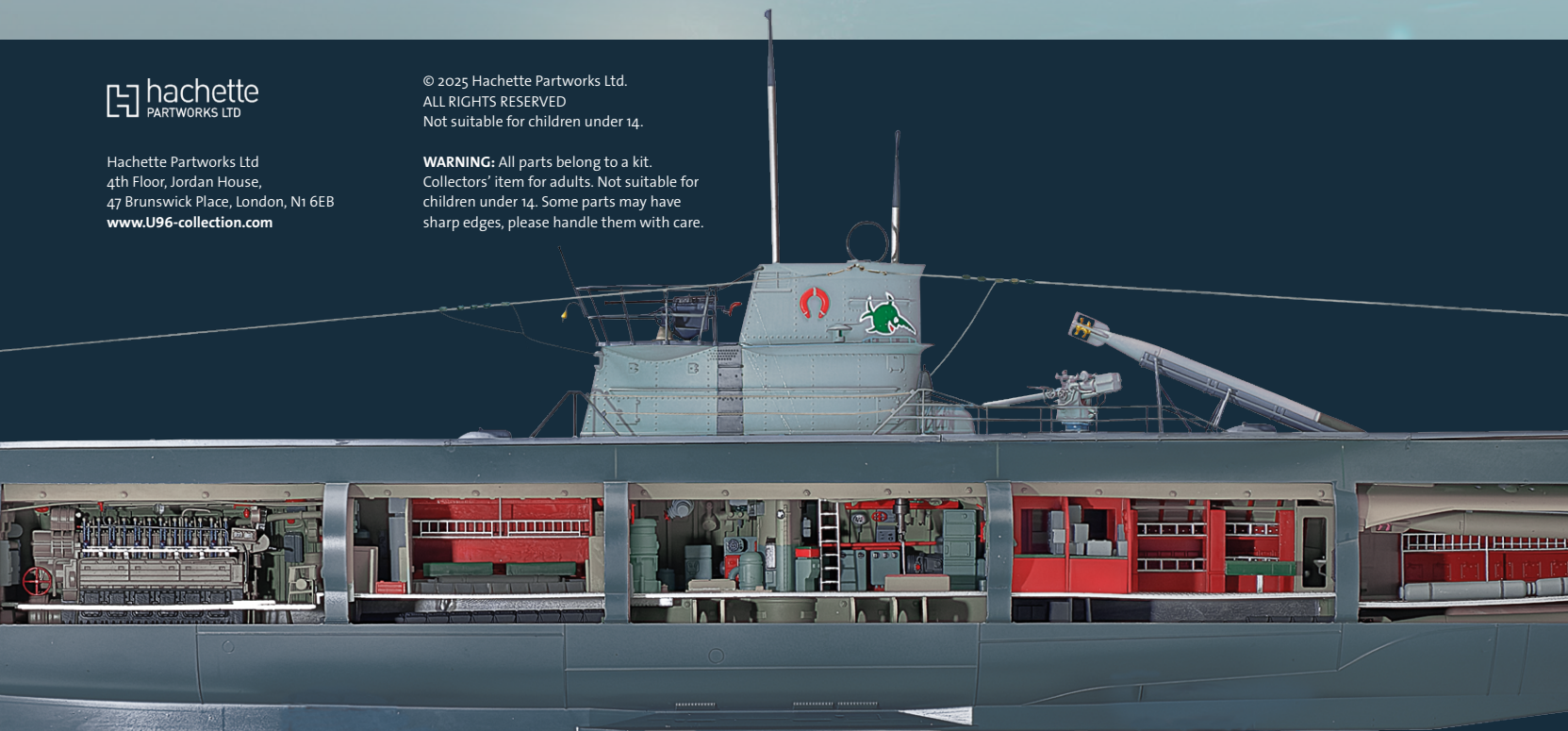

# Kit 109: Aft diving plane

In this kit, two hull plates are attached to the main structure. The two parts of the aft diving plane are fitted to the shaft and secured along with deflector rods and shaft brackets. The diving plane motor is mounted.

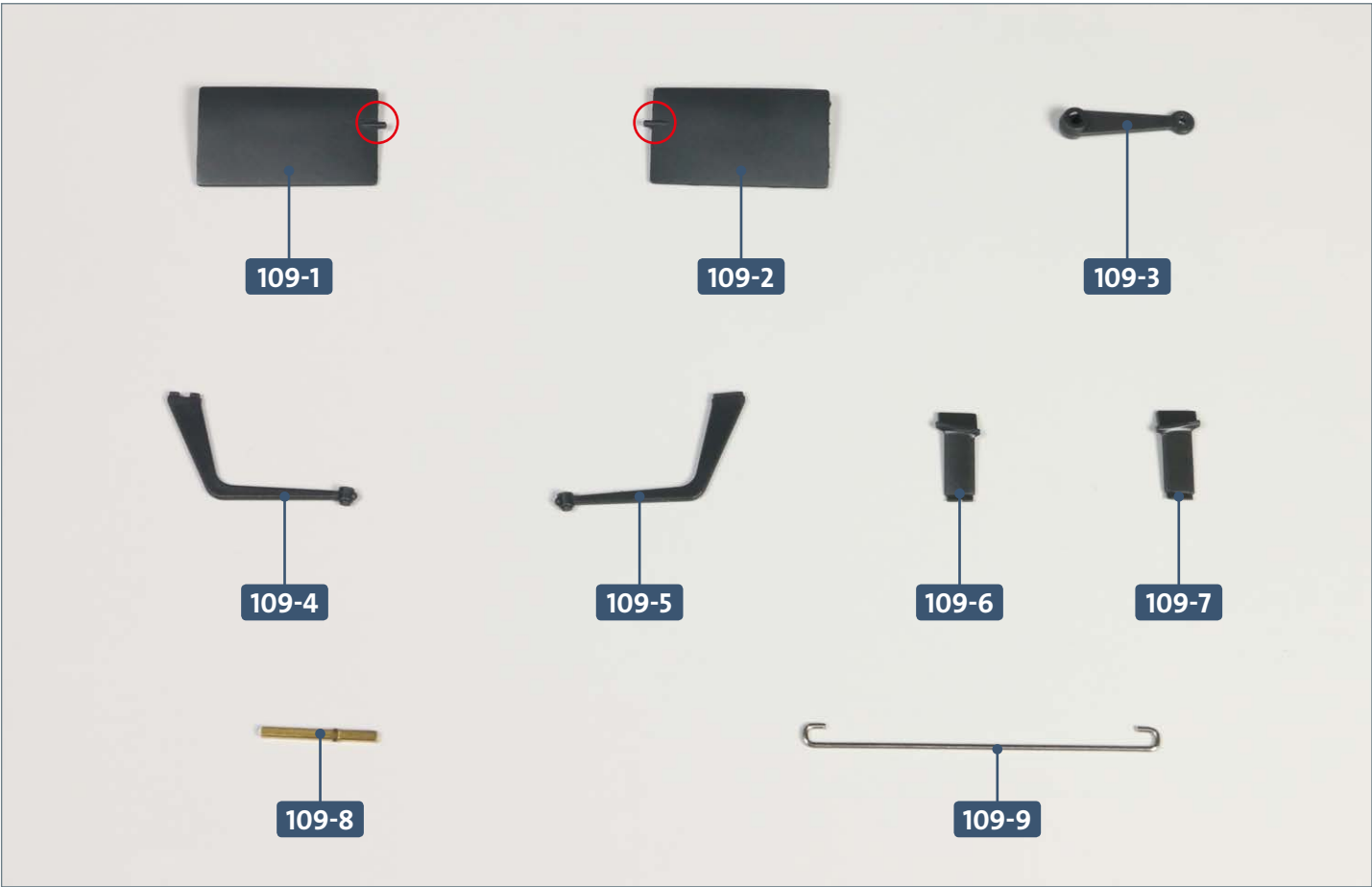

Parts reference list	
Part no.	Name
109-1	Aft port (L) diving plane
109-2	Aft starboard (R) diving plane
109-3	Control rod lever
109-4	Port (L) deflector rod
109-5	Starboard (R) deflector rod
109-6	Port (L) shaft bracket
109-7	Starboard (R) shaft bracket
109-8	Shaft
109-9	Control rod

**Notes:**  
The two diving planes differ in the position of the peg, circled in red. The shaft of the peg, visible on one side of the diving plane, must be at the bottom on both sides of the model (see red circles, steps 5 and 11).



Screws		
Ref	No.	Dimensions
CP	6 + 1	2 x 4 mm (PWB)

## Kit 109: Aft diving plane

### STAGE 1 → Assembly of hull sections and aft diving plane

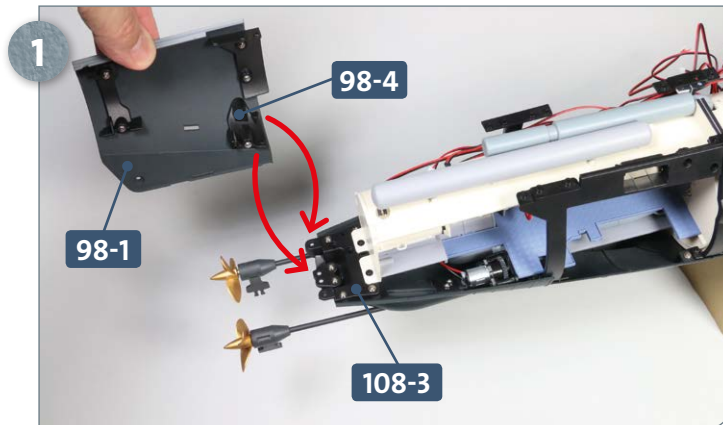

Place the main assembly on your work surface in preparation for fitting the port (L) hull section **98-1**. The previously fitted connector **98-4** fits beneath the connector **108-3**, as indicated by the arrows.

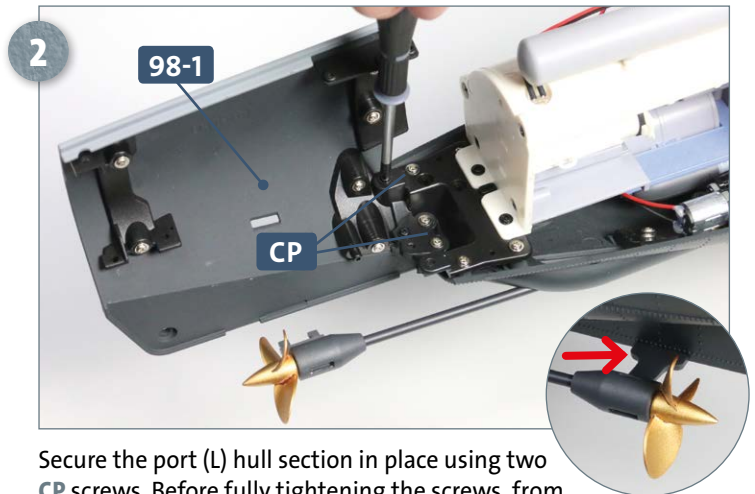

Secure the port (L) hull section in place using two **CP** screws. Before fully tightening the screws, from the outside, fit the propeller shaft support **105-1** into the slot in hull section **98-1** (see inset photo). After checking the fit of the support shaft (see step 3) fully tighten the screws.

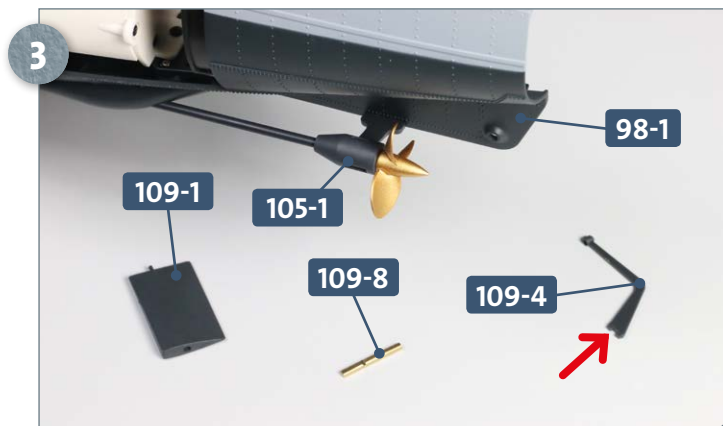

Working from the outside of hull plate **98-1**, have ready the port (L) diving plane **109-1**, the port (L) deflector rod **109-4**, (identifiable by the notch, see arrow), and the shaft **109-8**.

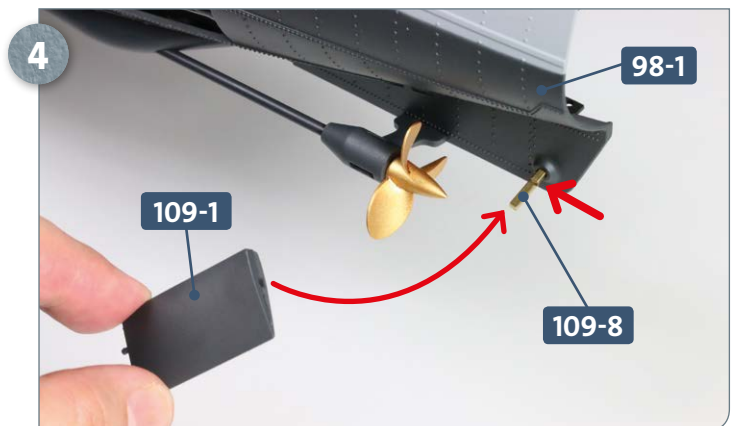

Insert the shaft **109-8** into the hole of hull plate **98-1**, so that the 'short' end protrudes (see straight arrow). Fit the square hole of the diving plane **109-1** onto this end of the shaft.

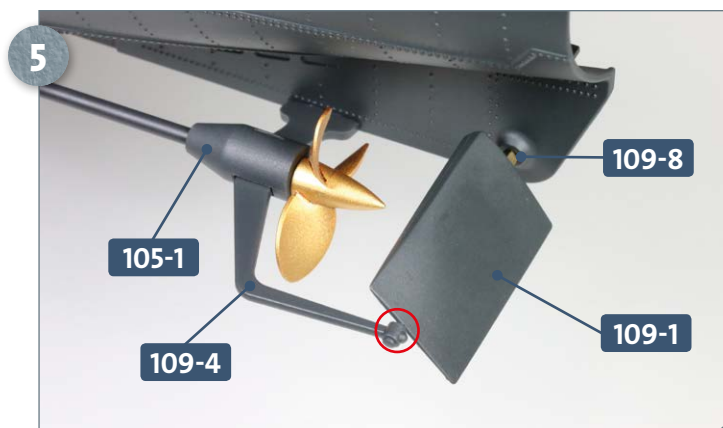

Glue the port (L) deflector rod **109-4** into the slot on the propeller shaft assembly **105-1**. The peg of the diving plane **109-1** circled in red is only inserted – not glued – into the small socket at the end of the deflector rod **109-4**.

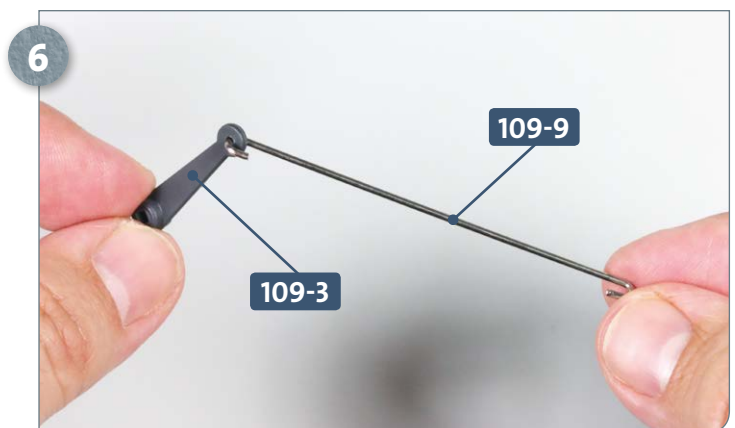

Insert one end of the control rod **109-9** into the small circular holder of the lever **109-3**, as pictured above.



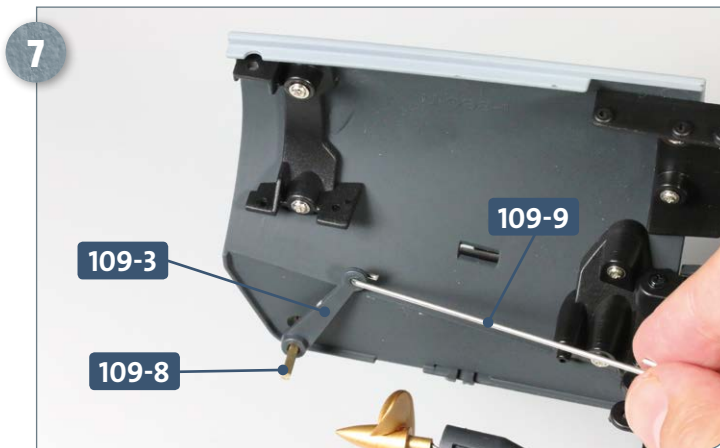

Fit the large hole at the other end of the lever **109-3** over the free end of the shaft **109-8**. Pay attention to the alignment of both the lever **109-3** and the control rod **109-9**.

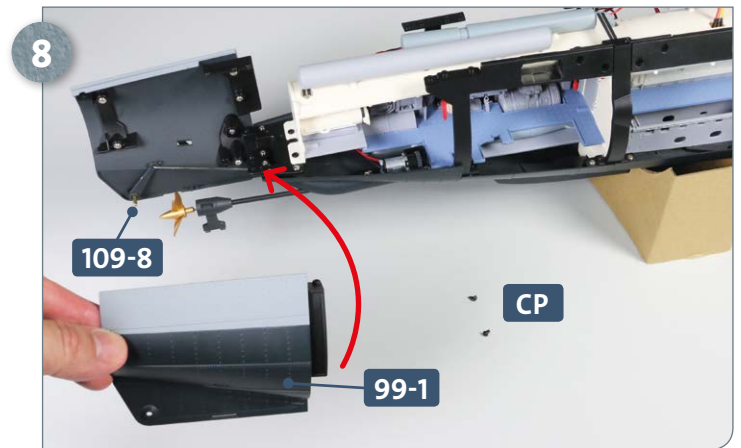

Have ready two **CP** screws. Take the port (L) hull section **99-1** and fit it onto the hull of the main structure as indicated by the arrow. The hole accommodates the free end of the shaft **109-8**.

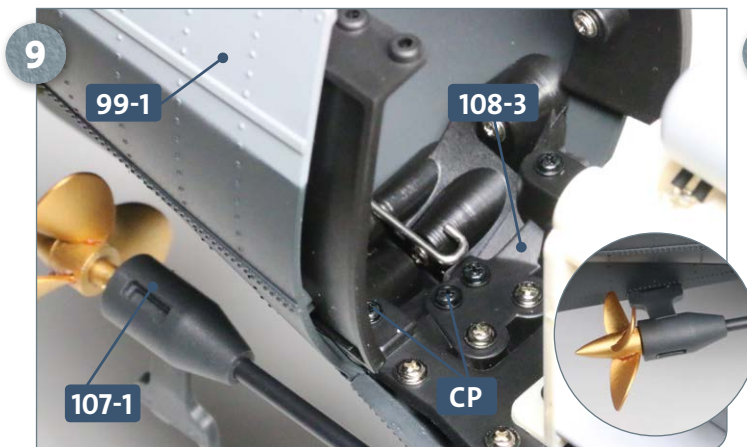

Secure the hull section **99-1** in place using two **CP** screws. Before fully tightening the screws, the propeller shaft support **107-1** needs to be fitted into the slot on the outside of hull section **99-1** (see inset photo). After checking the fit of the shaft support **107-1**, fully tighten the **CP** screws. See also the next step.

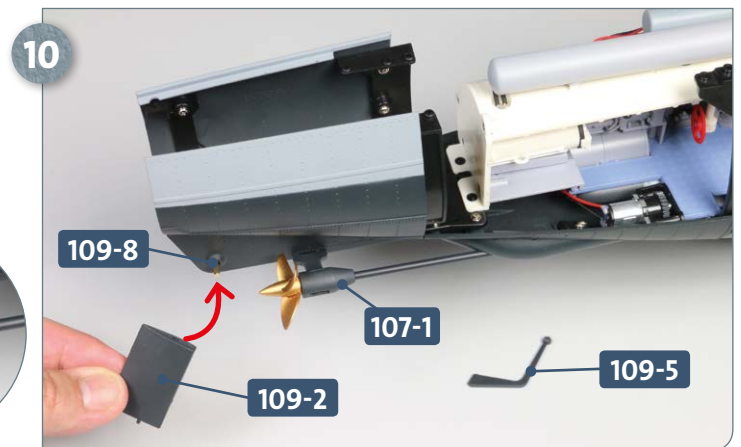

Fit the starboard (R) diving plane **109-2** onto the shaft **109-8**. It is important not to glue in place (and only if necessary) until the end of this assembly guide when the mechanism has been checked. Have ready the starboard (R) deflector rod **109-5**.

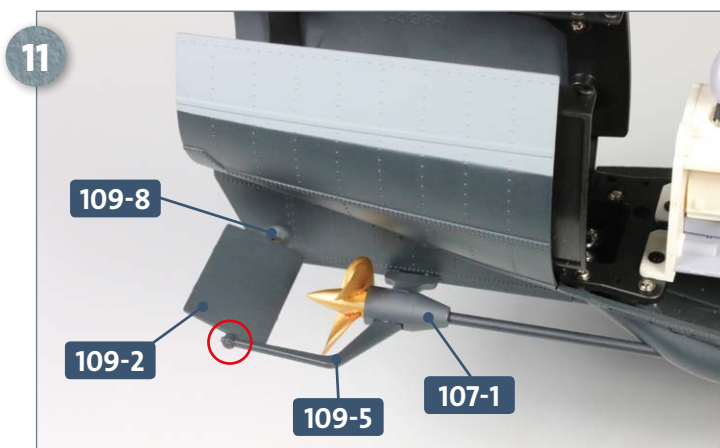

Glue the starboard (R) deflector rod **109-5** into the socket of the propeller shaft assembly **107-1**. The peg of the diving plane **109-2** (circled) is only inserted – not glued – into the small socket at the end of the deflector rod.

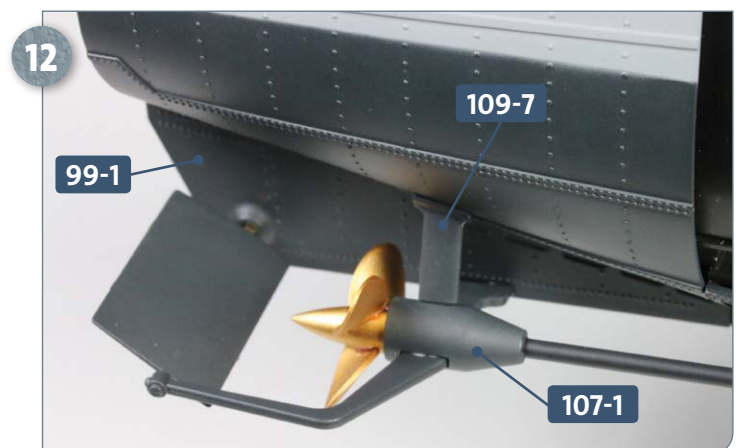

Take the starboard (R) shaft bracket **109-7** and fit it into the slot of the hull plate **99-1** and into the recess on the propeller shaft assembly **107-1**. Pay close attention to the orientation of the shaft bracket and, if necessary, glue in place.

## Kit 109: Aft diving plane

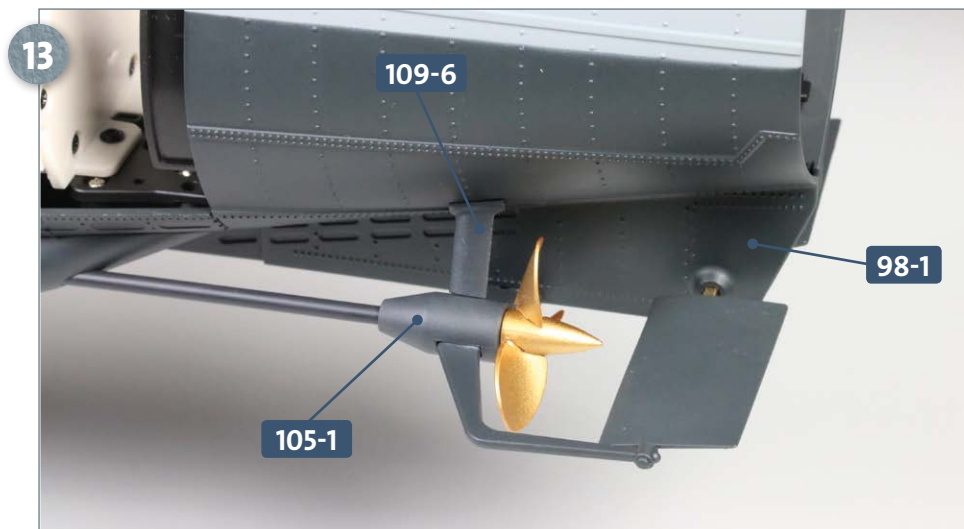

Now switch to the other side of the model: here, the port (L) shaft bracket **109-6** is fitted into the slot of hull plate **98-1** and the recess on propeller shaft assembly **105-1**. Once again, pay close attention to the alignment of the shaft bracket and, if necessary, glue in place.

### STAGE 2 → Installation of the aft diving plane motor

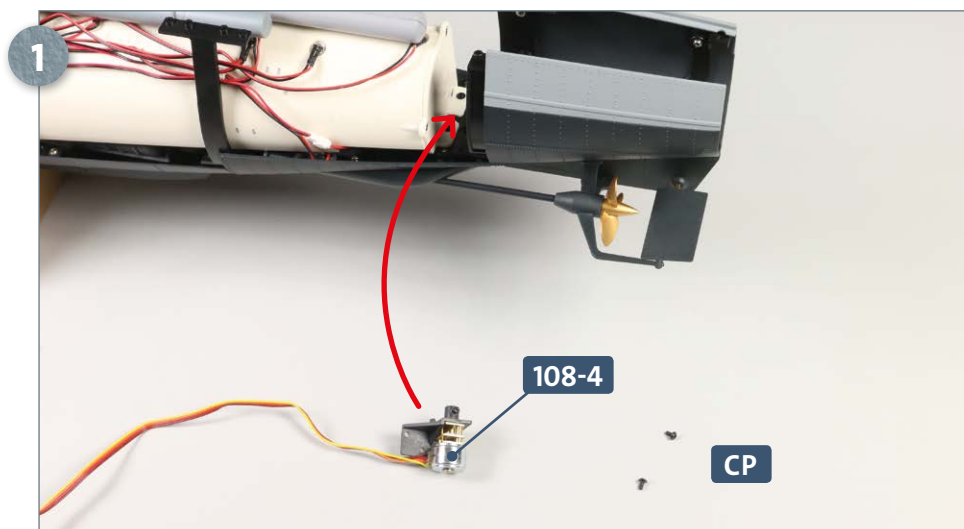

Have ready two **CP** screws and the aft diving plane motor assembly **108-4**, which you worked on in the last kit. The assembly will now be mounted in the aft of the model, in the position shown by the arrow.

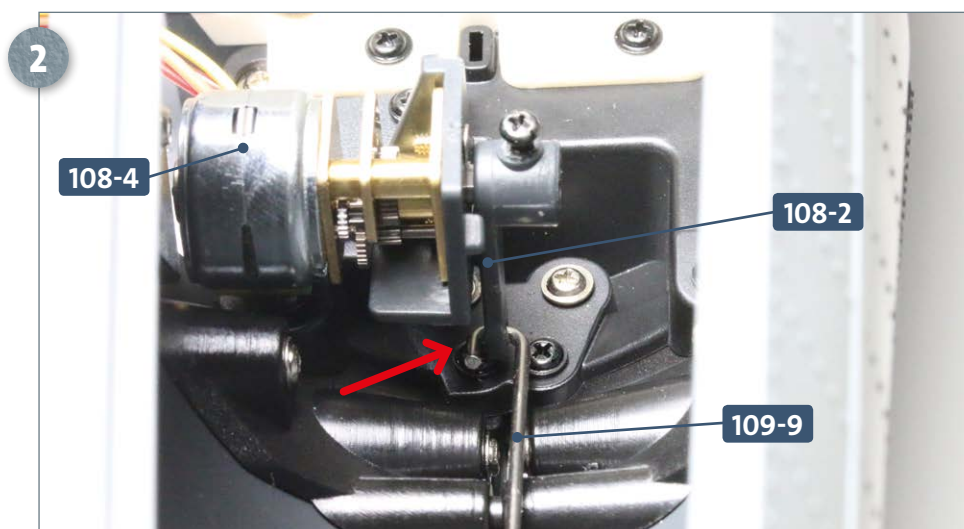

Insert the motor assembly **108-4** into the structure. Lever **108-2**, attached to the motor, receives control rod **109-9**: pass the bent end through the hole in the lever (indicated by the arrow).

## Kit 109: Aft diving plane

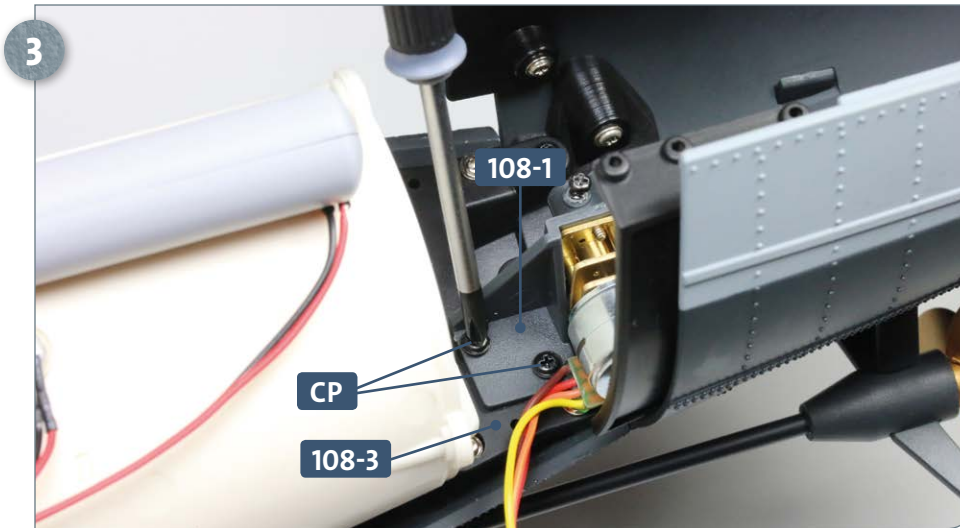

Fix the mounting plate **108-1** of the motor to the connector **108-3** using two **CP** screws.

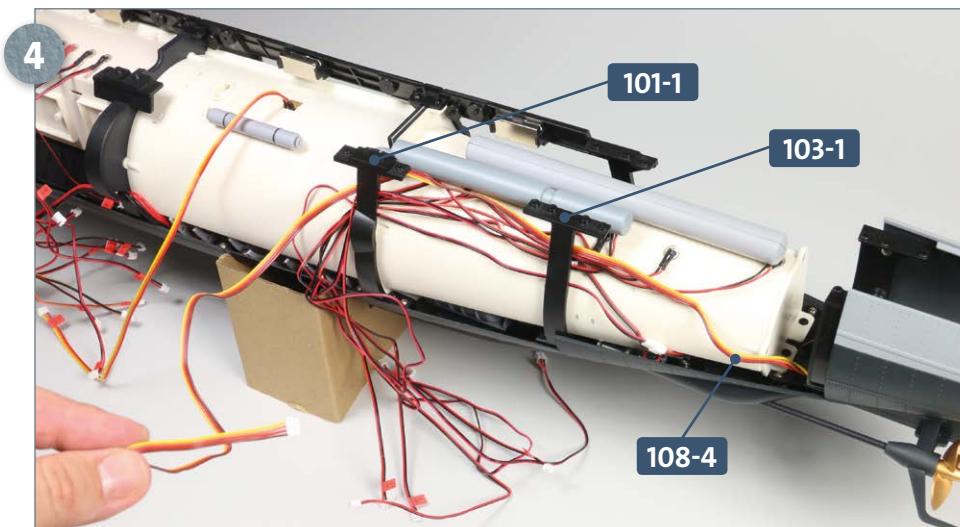

Route the cable of the motor **108-4** towards the bow behind connectors **103-1** and **101-1** on the port (L) side of the model, as shown in the photograph.

### COMPLETED WORK

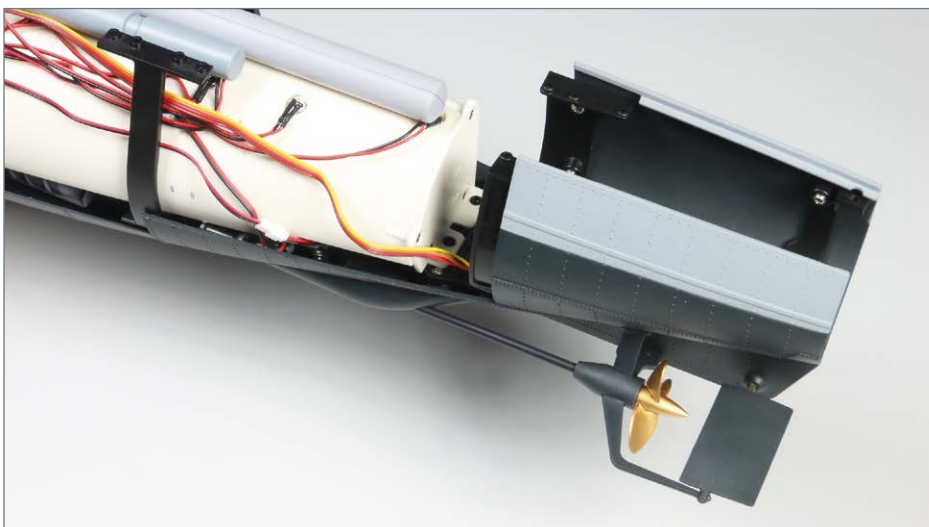

Two more hull sections have now been added, the diving planes are mounted, and the shafts are connected to the motor via a control rod.



# Kit 110: A new hull section

In this kit, you will fit a starboard (R) hull section with a metal plate and then attach it to the fourth compartment.

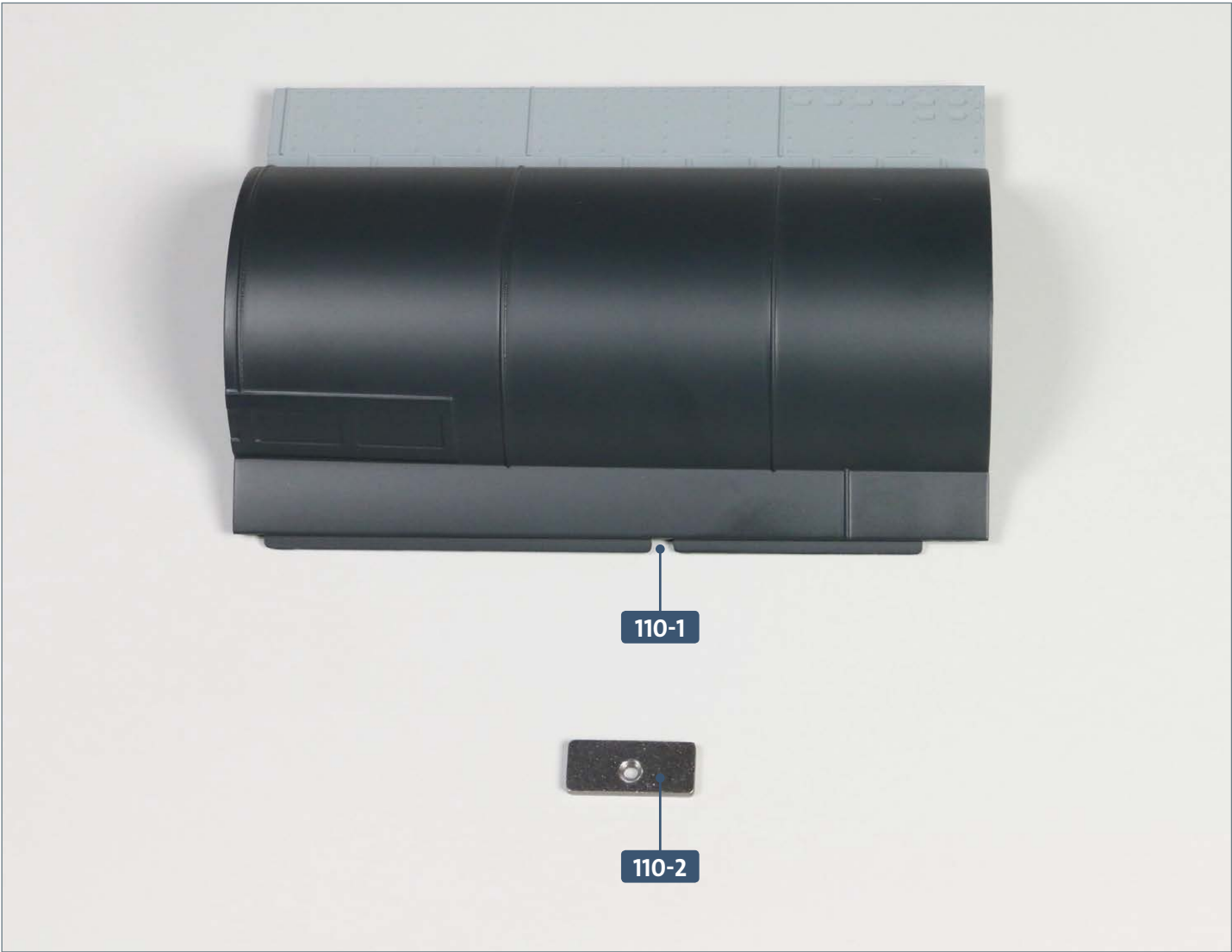

Parts reference list	
Part no.	Name
110-1	Starboard (R) hull section
110-2	Metal plate



Screws		
Ref	No.	Dimensions
EM	1 + 1	2 x 4 mm

**STAGE 1** → Attaching the hull section

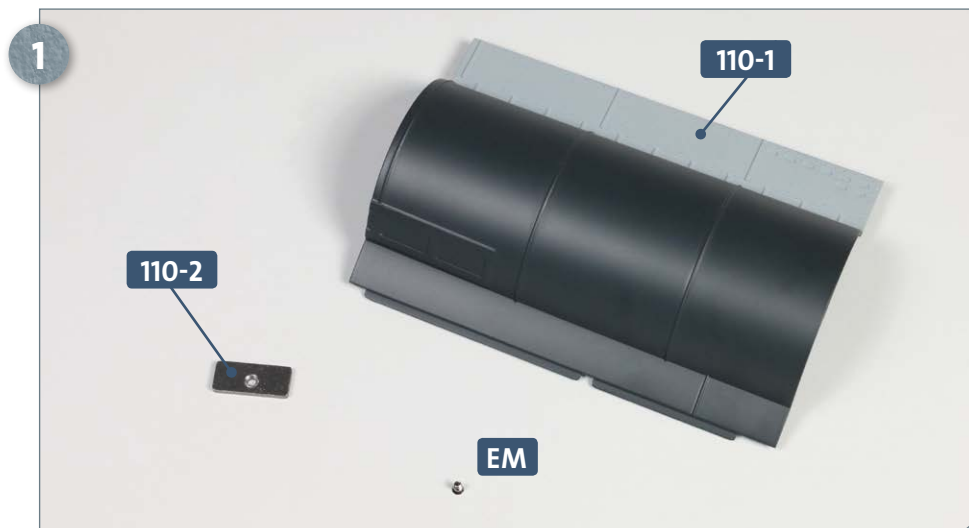

Place the starboard (R) hull section **110-1**, the metal plate **110-2** and one **EM** screw on your work surface, as pictured.



Turn the hull section **110-1** over. Take the metal plate **110-2** and fit it flush with the hole in the upper part of the hull section, as indicated by the arrow. The countersunk side of the plate **110-2** should face upwards.



Attach the metal plate **110-2** to the hull section **110-1** with the **EM** screw.



## Kit 110: A new hull section

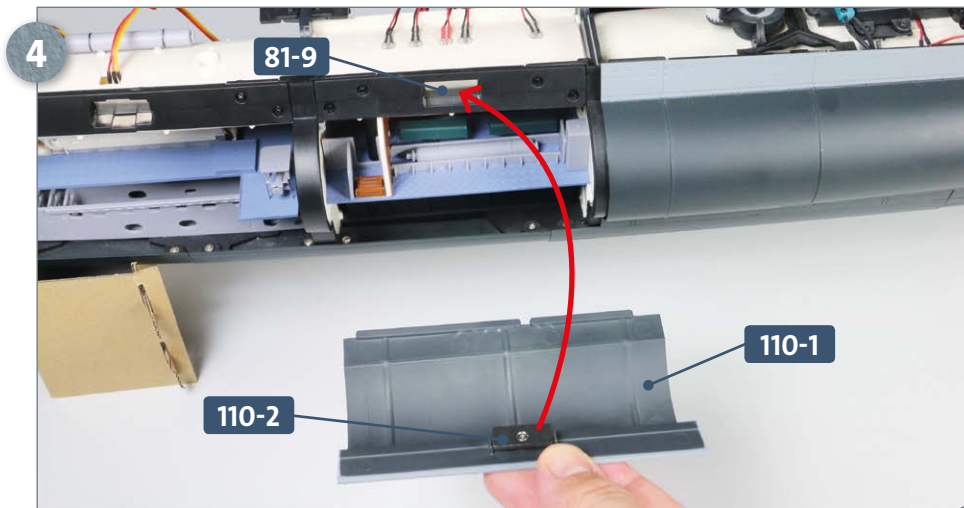

Place the model on your work surface so that you have access to the starboard (R) side. The hull section **110-1** will be fitted over the opening of the fourth compartment. The metal plate **110-2** fits onto the magnet **81-9**, as indicated by the arrow.

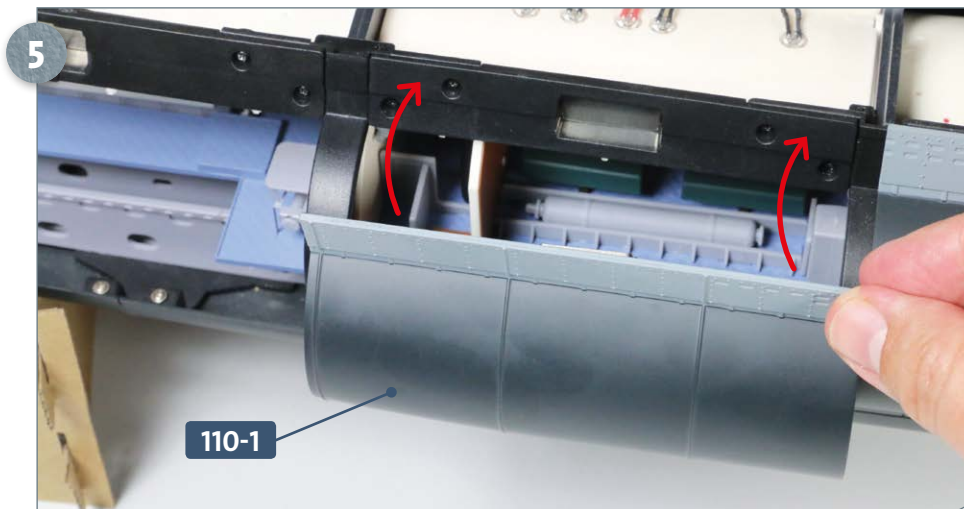

Placing the lower lip of the hull section **110-1** on the edge of the keel beneath the fourth compartment, tilt the hull section upwards as shown by the two red arrows.

## COMPLETED WORK

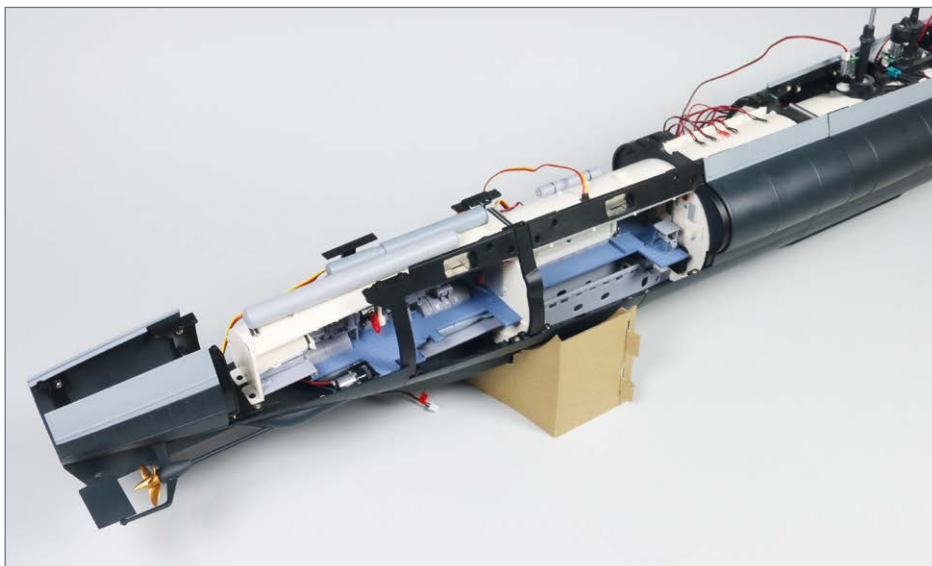

This newly installed hull section is designed to be removable and neatly covers the opening in the fourth compartment.

# Kit 111: Another hull section

In this kit, another starboard (R) hull section is fitted with a metal plate to create a detachable cover for the fifth compartment of the U-Boat.

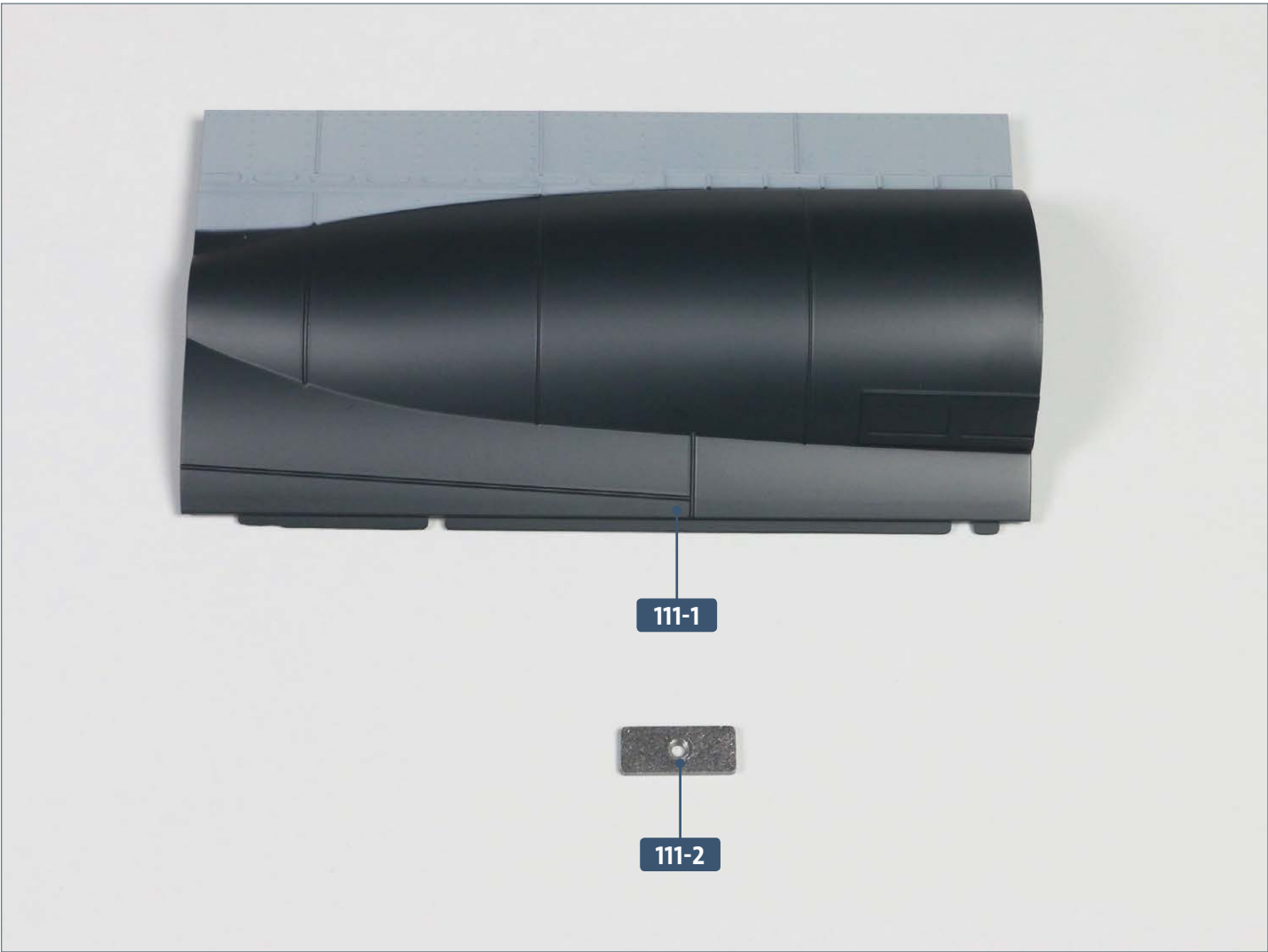

Parts reference list	
Part no.	Name
111-1	Starboard (R) hull section
111-2	Metal plate



Screws		
Ref	No.	Dimensions
EM	1 + 1	2 x 4 mm

## Kit III: Another hull section

### STAGE 1 → Installing the hull section

1



Lay the hull section **111-1** on your work surface with the inner side facing up. Take the metal plate **111-2**, fit it flush with the hole in the hull section and secure it with an **EM** screw, as pictured.

2

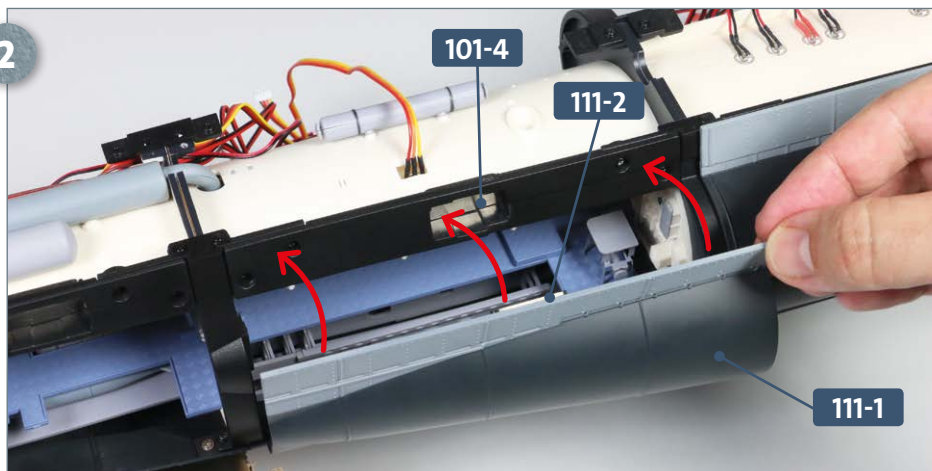

Place the model on your work surface so that you have access to the starboard (R) side. Fit the lip at the bottom of the hull section **111-1** onto the edge of the keel section beneath the fifth compartment. Tilt the hull section **111-1** upwards until the metal plate **111-2** sits against the magnet **101-4**, as indicated by the middle arrow.

### COMPLETED WORK



The next section of the starboard (R) hull has now been added to your U-Boat model.



# Kit 112: Port tail section

In this kit, two connectors are attached to the port (L) tail section, along with the port (L) rudder and a swivel gear.

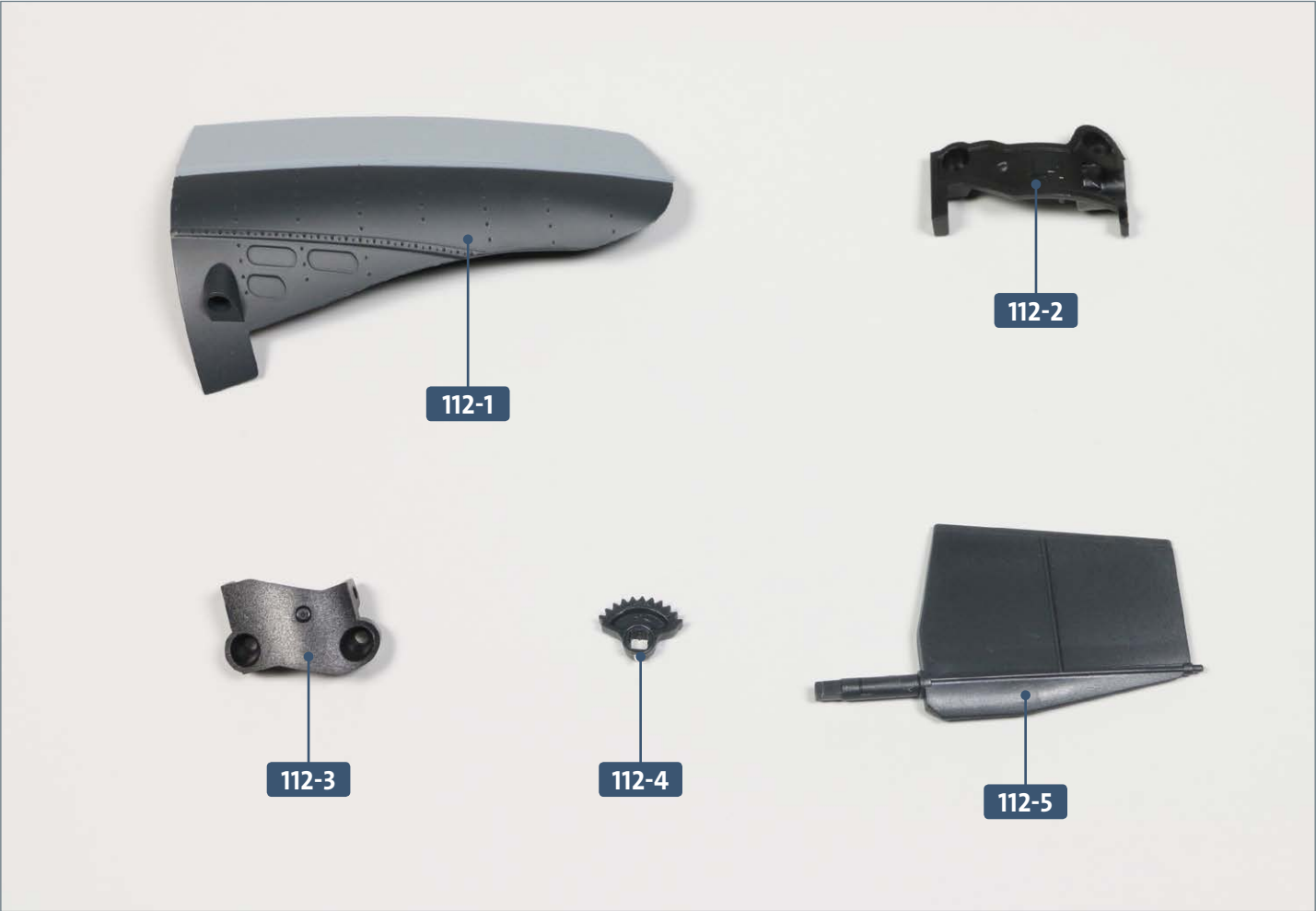

Parts reference list		
Part no.	Name	
112-1	Port (L) tail section	
112-2	Connector	
112-3	Connector	
112-4	Swivel gear	
112-5	Port (L) rudder	



Screws		
Ref	No.	Dimensions
FM	4 + 1	2 x 4 mm
HP	1 + 1	1.7 x 4 mm

## Kit 112: Port tail section

### STAGE 1 → Work on the port (L) tail section

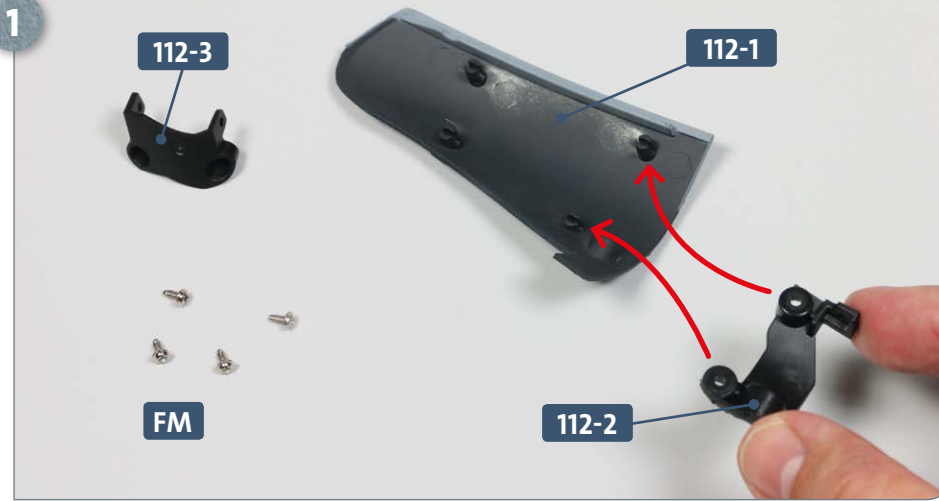

Place the port (L) tail section **112-1**, both connectors **112-2** and **112-3** and four **FM** screws on your work surface. Take connector **112-2** and fit it onto the two raised sockets at the forward end of the tail section, as indicated. Pay attention to the correct orientation of the connector.

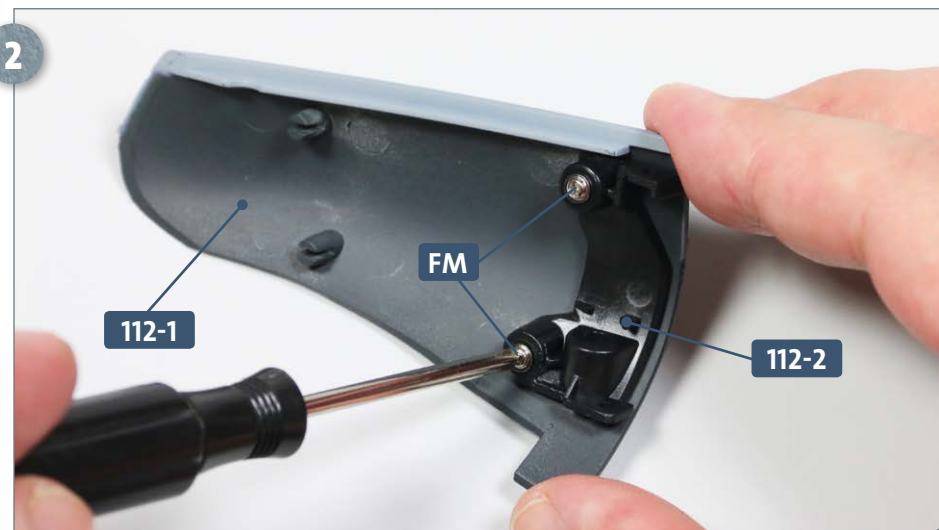

Attach the connector **112-2** in place using two **FM** screws.



Fit connector **112-3** onto the two raised sockets at the aft end of the tail section **112-1** and fix in place using the other two **FM** screws.

## Kit 112: Port tail section

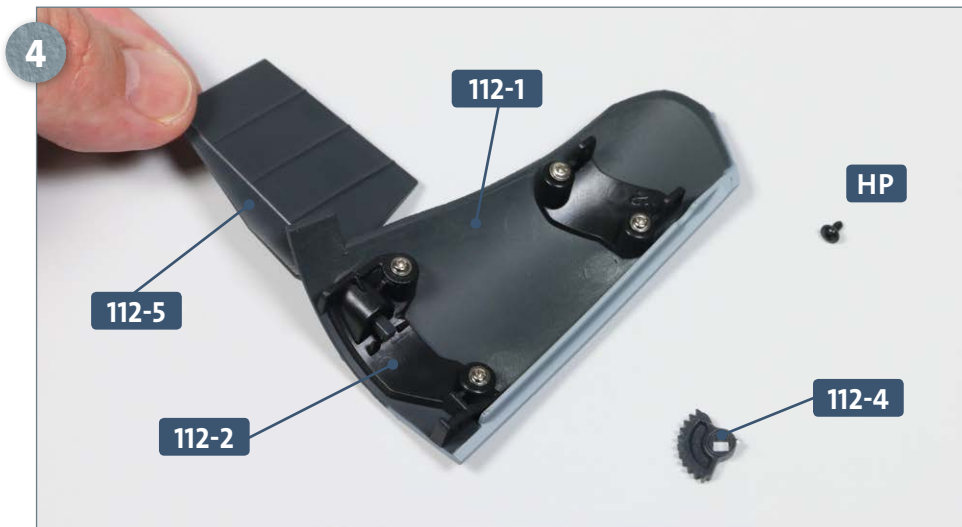

Have ready the swivel gear **112-4** and one **HP** screw. Take the port (L) rudder **112-5** and guide its shaft through the hole in the tail section **112-1** and into the connector **112-2**, as shown in the photo.

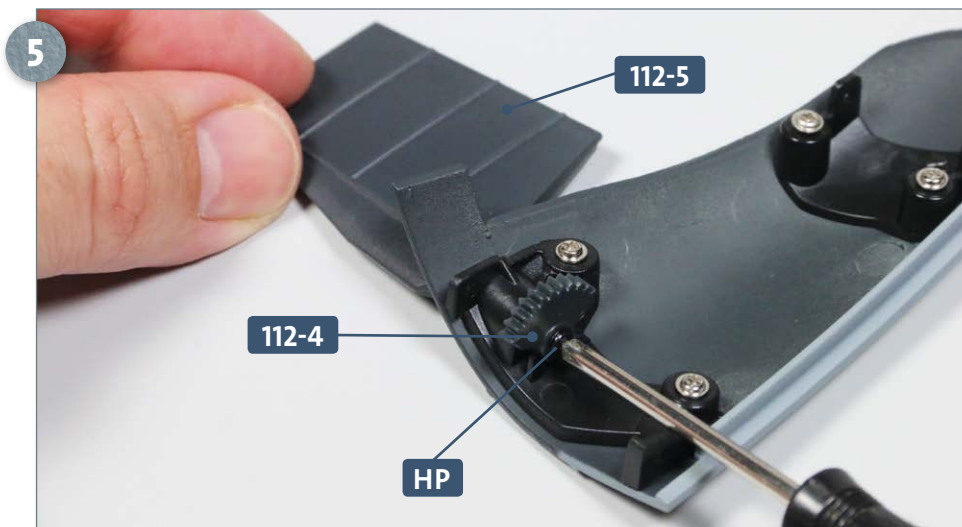

Fit the swivel gear **112-4** on the shaft end of the rudder **112-5** and fasten in place using the **HP** screw. Pay attention to the correct orientation of the gear.

## COMPLETED WORK



**Two connectors and the port (L) rudder have now been attached to the port (L) tail section.**