

# THE ICONIC **FORD** **FALCON XB GT**

SCALE  
1:8



Rear Seat Assembly

Published weekly  
UK: £10.99 AUS: \$21.99



9 772976 581050



## POST-APOCALYPTIC EDITION



# THE ICONIC FORD FALCON XB GT

ISSUE 80

## ASSEMBLY GUIDE

3

The rear seat is assembled and fitted to the floor, and the floor is attached to the chassis.

## YOUR MODEL

You will be building a 1:8 scale replica of a customised 1973 Ford Falcon XB GT. Features include a lift-up bonnet that reveals a detailed engine, opening doors, wind-down windows and an 'active' steering wheel. A remote-control fob illuminates the main lights, brake lights and indicators.

Scale: 1:8  
Length: 62cm  
Width: 25cm  
Height: 19cm  
Weight: 7+kg



Official  
Licensed Product

Ford Motor Company  
trademarks and trade dress  
used under licence to GRE  
for Groupe ELIGOR

### CUSTOMER SERVICE, SUBSCRIPTIONS & BACK ORDERS

Please visit [hachettepartworks.com/contact](https://hachettepartworks.com/contact) to get in touch.

Published by Hachette Partworks Ltd  
4th Floor, Jordan House, 47 Brunswick Place,  
London, N1 6EB  
[www.hachettepartworks.com](https://www.hachettepartworks.com)



© 2026 Hachette Partworks Ltd  
© 2026 Ford Motor Company  
Distributed in the UK and Republic of Ireland by Marketforce.  
Printed in the United Kingdom  
ISSN 2976-5811

Complete in 130 issues.

### ALL RIGHTS RESERVED

Items may vary from those shown.  
All parts belong to a kit. Collectors' item for adults. Not suitable for children under 14. Some parts may have sharp edges, please handle them with care.

The installation of electronic parts must always be carried out by an adult. When replacing batteries, use the same type of batteries. Please ensure that the battery compartment is securely fastened before you use the model again. Used batteries should be recycled. Please make sure to check with your local council how batteries should be disposed of in your area. Batteries can present a choking danger to small children and may cause serious harm if ingested. Do not leave them lying around and keep any spare batteries locked away at all times.

The editor's policy is to use papers that are natural, renewable and recyclable products and made from wood grown in sustainable forests. The logging and manufacturing processes are expected to conform to the environmental regulations of the country of origin.

In the event of a significant increase in production and transport costs, the publisher reserves the right to modify its selling prices.

**MANAGING DIRECTOR** – Isabelle Couderc  
**EDITORIAL DIRECTOR** – Helen Nally  
**MARKETING DIRECTOR** – Elise Windmill  
**PRODUCTION DIRECTOR** – Sema Sant Anna  
**SENIOR PRODUCTION MANAGER** – Lee Matthews  
**MANAGING EDITOR** – Sarah Gale  
**PROJECT EDITOR** – Gary Webb  
**DISTRIBUTION MANAGER** – Paul Smith  
**PRODUCT MANAGER** – Rhys Myrner



For our  
environmental  
policy in full  
please scan the  
QR code here



**NOT SUITABLE FOR CHILDREN  
UNDER THE AGE OF 14.**  
This product is not a toy and is  
not intended for use in play.

Editorial and design: Windmill Books Ltd

Picture credits:

Front cover: Jess Esposito and David Burton, main;  
Richard Bryden: bl; Steven Giles background.

Step-by-step photography: Richard Bryden

Model photography: Jess Esposito and David Burton

Windmill Books has made every attempt to contact the copyright holder, if you have any information please contact Sophie Mortimer: [smortimer@windmillbooks.co.uk](mailto:smortimer@windmillbooks.co.uk)

t=top, c=centre, b=bottom, l=left, r=right, u=upper





# Stage 80: Rear Seat Assembly

The rear seat is assembled and fitted to the floor, and the floor is attached to the chassis.



## List of parts:

- 80A** Rear seat foam
- 80B** Rear seat cover
- 80C** Rear seat underside panel
- PS25** Eleven\* 2.3 x 5mm PB screws

\* Including spare

PB = Pan head for plastic

## Area of assembly

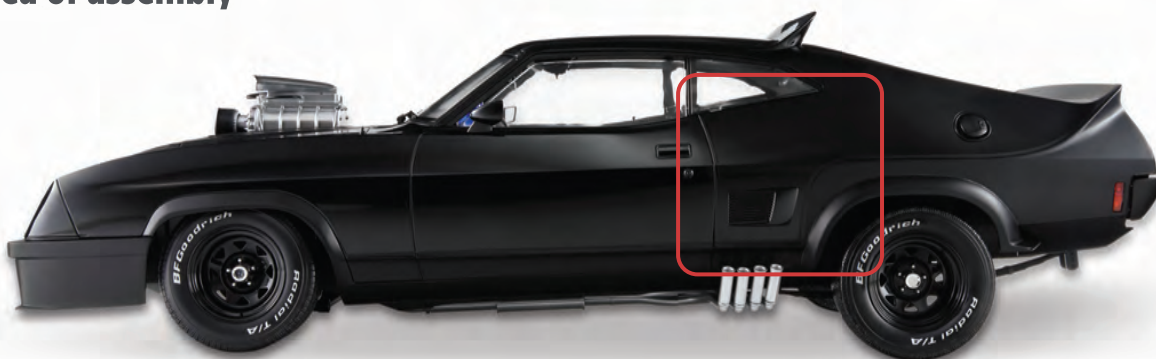



## Stage 80: Rear Seat Assembly

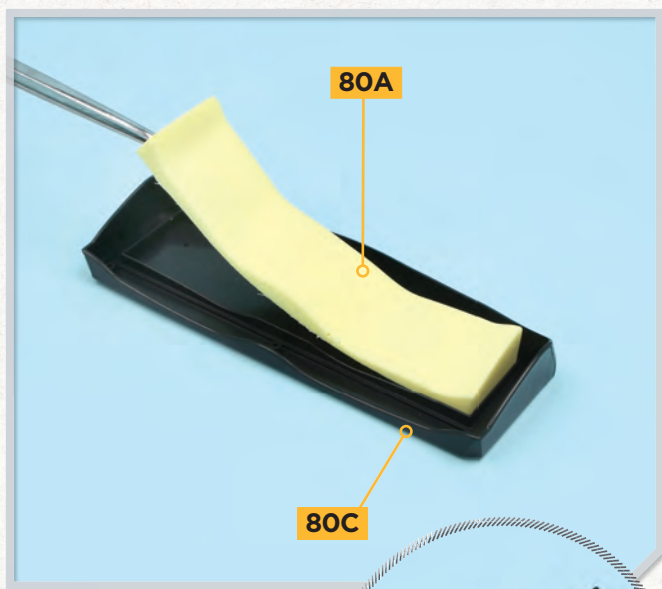

### STEP 1

Fit the foam **80A** inside the underside panel of the rear seat **80C**. Note that the flat side of the foam is positioned on the flat face inside part **80C**.

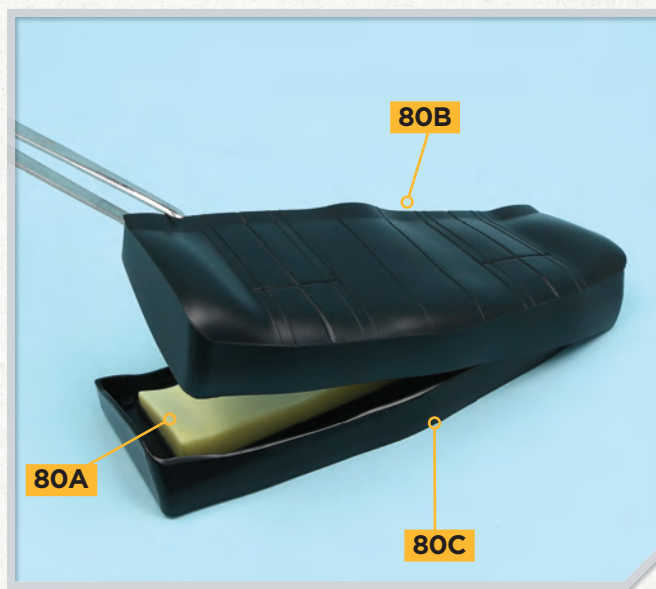

### STEP 2

Take the back seat cover **80B** and fit it over the foam **80A**. Ease the edges of the seat cover **80B** over the edge of the underside seat panel **80C**.



### STEP 3

Check how the seat back assembly from the previous issue fits against the rear seat assembly: the rear edge of the seat fits into the channel in the lower edge of the seat back **79B** so that the screw holes are aligned.



### STEP 4

Fix the two parts of the seat together with three **PS25** screws.

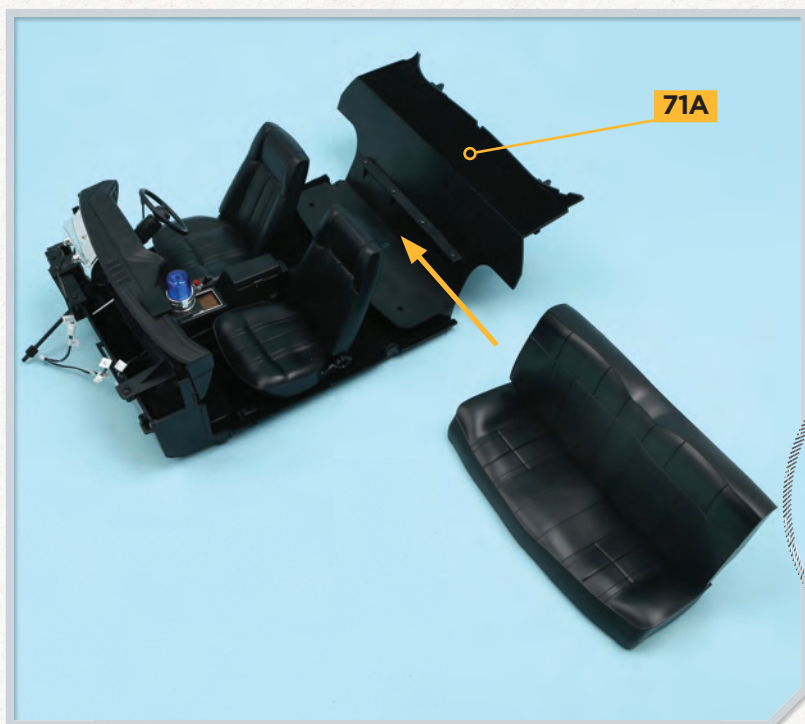

**STEP 5**

Take the floor assembly from issue 77. Carefully fit the rear seat at the back of the floor, against the shaped rear floor section **71A**. Turn the floor on one side so that you can fix the rear seat in place with three **PS25** screws (below).

**STEP 6**

Take the chassis assembly from issue 63. Carefully position the floor/seat assembly: the cog on the end of the steering shaft is positioned in a rectangular 'box' near the right front wheel (arrow, right). Make sure that all the cable connectors are accessible between the dashboard and the engine.

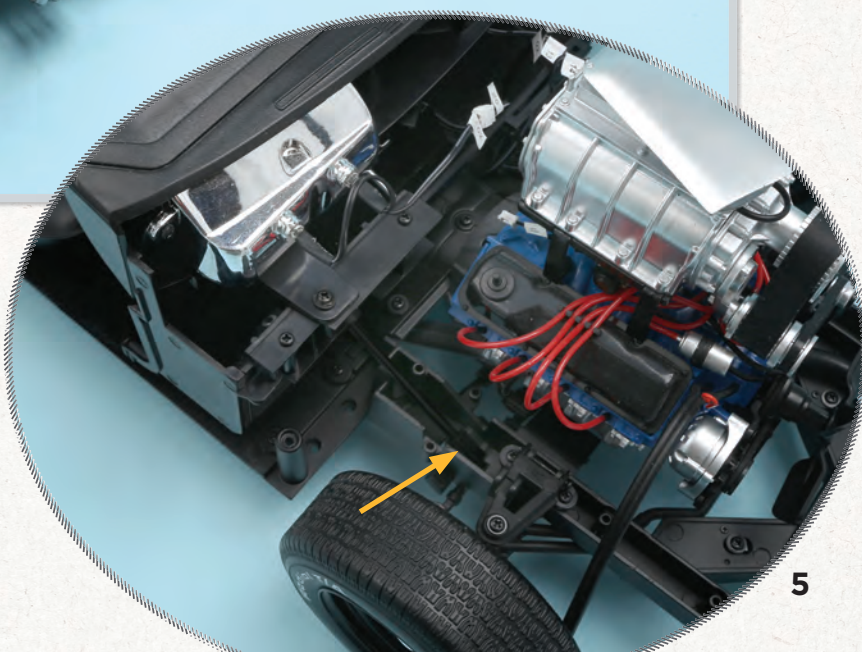



## Stage 80: Rear Seat Assembly

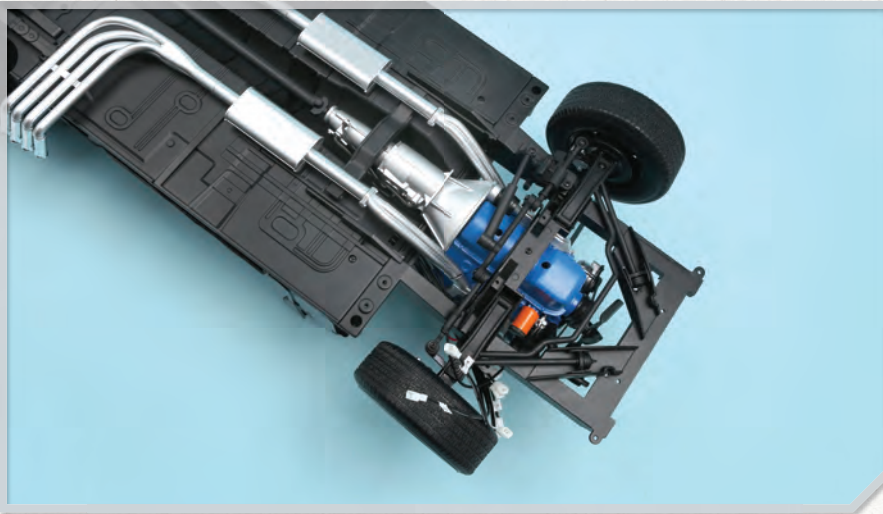

### STEP 7

Carefully position the assembly so that you can access the underside of the chassis. You will need four **PS25** screws to fix the floor assembly to the chassis.

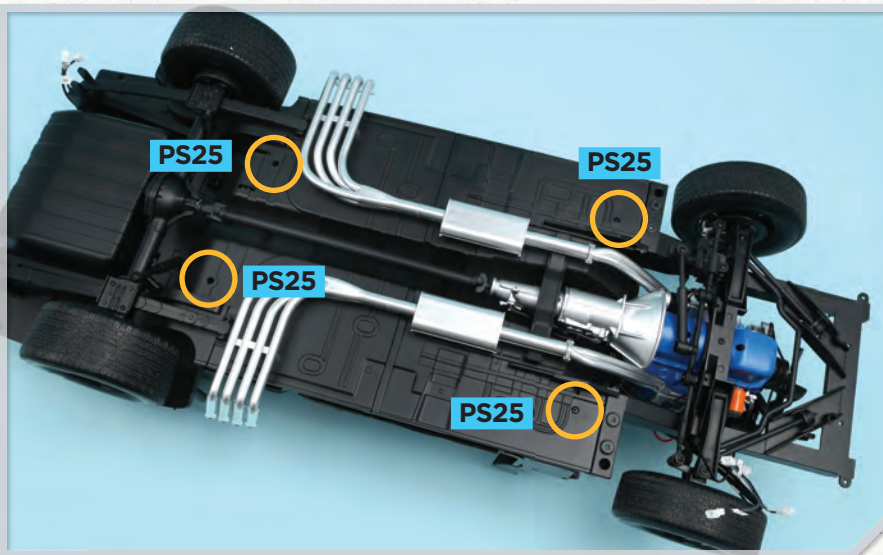

### STEP 8

Fix the four **PS25** screws at the positions circled (left).



### STEP 9

Identify the cables with connectors marked 02. There is a 'forked' cable **67J** from the dashboard lights: the unmarked connector with two cables has to be connected to a cable **38E** marked 02 that runs out from between the floor and the chassis.



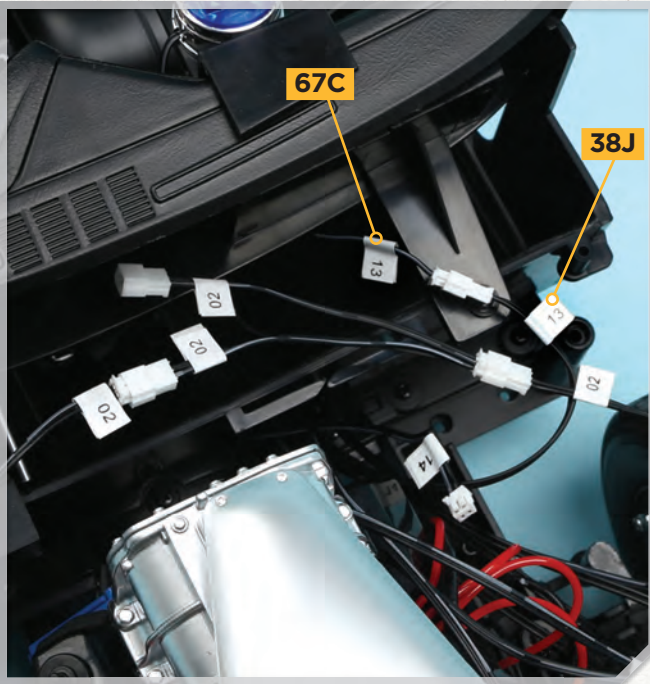

## STEP 10

Identify the cables with connectors marked 13. There is a cable **67C**, marked 13, connected to the blue light, that has to be connected to cable **38J**, also marked 13.

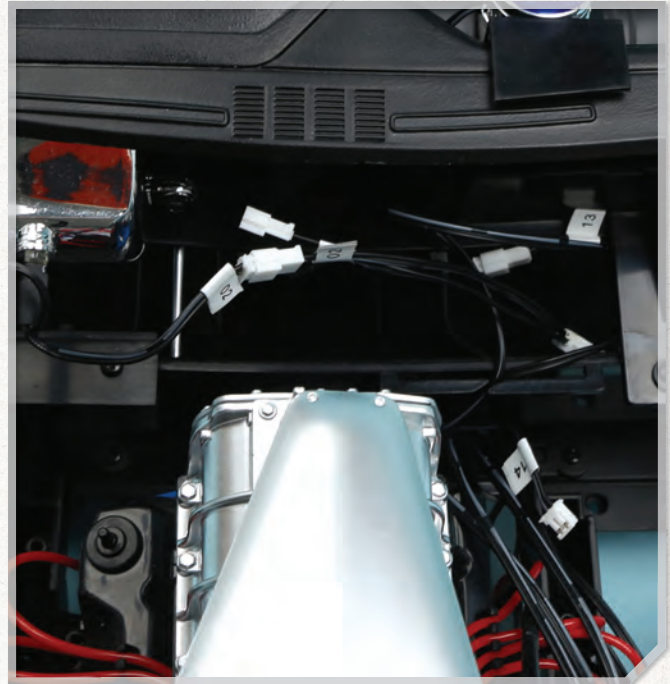

## STEP 11

Carefully tuck the connections 02 and 13 in between the dashboard and the engine.



## COMPLETED ASSEMBLY

The rear seat has been fitted to the floor, and the floor assembly has been attached to the chassis.



# COMING IN ISSUE 81



## • ASSEMBLY GUIDE

The side wall of the engine bay, the steering control mechanism and the right shock absorber are all fitted to the model.

## NEW PARTS

Shock absorber rod, pin, shock absorber tube, engine bay right wall, spring, steering column cog holder, electrical detail and screws.

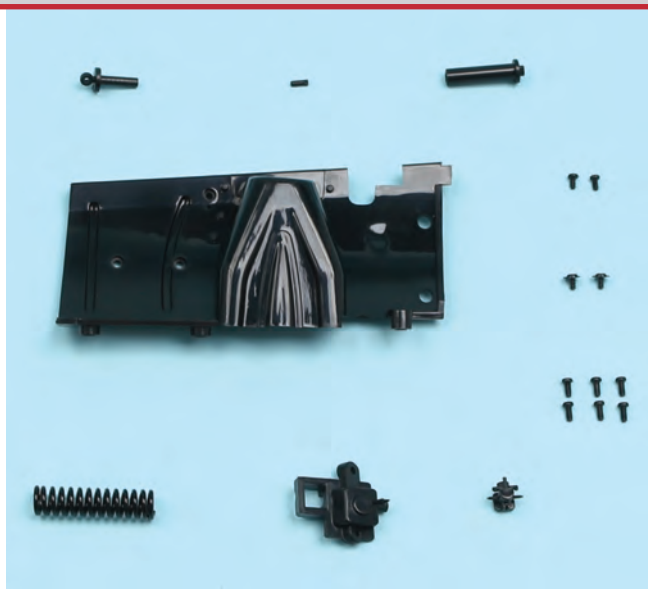

Published weekly

UK: £10.99

AUS: \$21.99



[hachettepartworks.com/FordFalcon](http://hachettepartworks.com/FordFalcon)